

HARLINGEN®

INDEXABLE THREAD TURNING TOOL

Made of hardened alloy steel and HRC43-46.

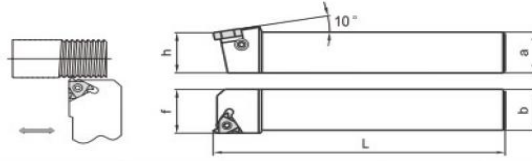

Order No.		Model		Size(mm)					Insert	Screw	Torx wrench	Shim	Shim scerw	Hex wrench	Unit Price FOB
Right hand	Left hand	Right hand	Left hand	h	a	b	L	f							
211-17-001	211-17-002	SER1616H16T	SEL1616H16T	16	16	16	100	20	16ER../16EL..	L60 M3.5x14.0	T15	LT16/0.5 LT16/1.75	SS04008	S2.5	US\$11.55
211-17-003	211-17-004	SER2020K16T	SEL2020K16T	20	20	20	125	25	16ER../16EL..						US\$12.38
211-17-005	211-17-006	SER2525M16T	SEL2525M16T	25	25	25	150	32	16ER../16EL..						US\$13.58
211-17-007	211-17-008	SER3225P16T	SEL3225P16T	32	32	25	170	32	16ER../16EL..						US\$14.85
211-17-009	211-17-010	SER3232P16T	SEL3232P16T	32	32	32	170	40	16ER../16EL..						US\$14.85
211-17-011	211-17-012	SER2525M22T	SEL2525M22T	25	25	25	150	32	22ER../22EL..	L60 M4x15.0	T15	LT22	SS04008	S2.5	US\$13.58
211-17-013	211-17-014	SER3225P22T	SEL3225P22T	32	32	25	170	32	22ER../22EL..						US\$14.85
211-17-015	211-17-016	SER3232P22T	SEL3232P22T	32	32	32	170	40	22ER../22EL..						US\$14.85

INDEXABLE THREAD BORING BAR

Made of hardened alloy steel and HRC43-46.

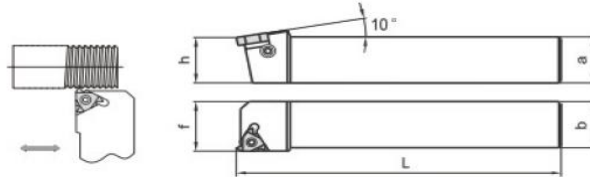

Order No.		Model		Size(mm)							Insert	Screw	Torx wrench	Shim	Shim scerw	Hex wrench	Unit Price FOB
Right hand	Left hand	Right hand	Left hand	d	f	L	h	B	l1	Dmin							
221-17-001	221-17-002	SNR0010H11	SNL0010H11	10	7.2	100	9	9.5	25	12	11NR../11NL..	L60M2.5x5.2	T8	-	-	-	US\$10.35
221-17-003	221-17-004	SNR0012K11	SNL0012K11	12	9	125	11	11.5	32	16	11NR../11NL..						US\$11.10
221-17-005	221-17-006	SNR0016M16	SNL0016M16	16	12	150	15	15.5	32	20	16NR../16NL..	L60M3.5x8.8	T15	-	-	-	US\$11.93
221-17-007	221-17-008	SNR0020Q16	SNL0020Q16	20	14	180	18	19	40	25	16NR../16NL..						US\$13.20
221-17-009	221-17-010	SNR0025R16	SNL0025R16	25	17	200	23	24	45	30	16NR../16NL..	L60 M3.5x14.0	T15	LT16/0.5 LT16/1.75	SS04008	S2.5	US\$14.25
221-17-011	221-17-012	SNR0032S16	SNL0032S16	32	22	250	30	31	60	38	16NR../16NL..						US\$18.00
221-17-013	221-17-014	SNR0040T16	SNL0040T16	40	27	300	37	38.5	75	50	16NR../16NL..						US\$23.25
221-17-015	221-17-016	SNR0050U16	SNL0050U16	50	35	350	47	48.5	90	63	16NR../16NL..						US\$39.00
221-17-017	221-17-018	SNR0025R22	SNL0025R22	25	17	200	23	24	45	30	22NR../22NL..						US\$14.25
221-17-019	221-17-020	SNR0032S22	SNL0032S22	32	22	250	30	31	60	38	22NR../22NL..	L60 M4x15.0	T15	LT22	SS04008	S2.5	US\$18.00
221-17-021	221-17-022	SNR0040T22	SNL0040T22	40	27	300	37	38.5	75	50	22NR../22NL..						US\$23.25
221-17-023	221-17-024	SNR0050U22	SNL0050U22	50	35	350	47	48.5	75	63	22NR../22NL..						US\$39.00

Shim LT16/0.5 fit to insert of pitch 0.5~1.5mm, Shim LT16/1.75 fit to insert of pitch 1.75~3.0mm.

ADD: C-8F NO.6, HANGKONG ROAD, FENGDE INTERNATIONAL PLAZA, CHENGDU, SICHUAN, CHINA
 TEL: 028-86741971 86741739 FAX: 028-86756837 86750017
 E-MAIL: sales@sctools.com service@sctools.com

SOLID CARBIDE THREADING INSERT

Made of micrograin solid carbide and with TiAlN coating.
General purpose used for steel, stainless steel and cast iron.

PRTRIAL PROFILE 60°



External



Internal

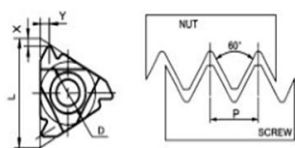

Order No.		Model		D (IC)	Lead&Pitch		Dimensions(mm)			Unit Price
Right hand	Left hand	Right hand	Left hand		mm	TPI	X	Y	L	TiAlN
302-01-001	302-01-002	11ER A 60	11EL A 60	1/4"	0.5~1.5	48~16	0.8	0.9	11.0	US\$2.67
302-01-003	302-01-004	16ER A 60	16EL A 60	3/8"	0.5~1.5	48~16	0.8	0.9	16.0	US\$2.67
302-01-005	302-01-006	16ER AG 60	16EL AG 60		0.5~3.0	48~8	1.2	1.7	16.0	US\$2.67
302-01-007	302-01-008	16ER G 60	16EL G 60		1.75~3.0	14~8	1.2	1.7	16.0	US\$2.67
302-01-009	302-01-010	22ER N 60	22EL N 60	1/2"	3.5~5.0	7~5	1.7	2.5	22.0	US\$4.50
302-01-011	302-01-012	27ER Q 60	27EL Q 60	5/8"	5.5~6.0	4.5~4	2.3	3.1	27.0	US\$7.67

Internal

Order No.		Model		D (IC)	Lead&Pitch		Dimensions(mm)			Unit Price
Right hand	Left hand	Right hand	Left hand		mm	TPI	X	Y	L	TiAlN
301-01-001	301-01-002	08IR A 60	08IL A 60	3/16"	0.5~1.5	48~16	0.8	0.6	8	US\$3.83
301-01-003	301-01-004	11IR A 60	11IL A 60	1/4"	0.5~1.5	48~16	0.8	0.9	11	US\$2.67
301-01-005	301-01-006	16IR A 60	16IL A 60	3/8"	0.5~1.5	48~16	0.8	0.9	16	US\$2.67
301-01-007	301-01-008	16IR AG 60	16IL AG 60		0.5~3.0	48~8	1.2	1.7	16	US\$2.67
301-01-009	301-01-010	16IR G 60	16IL G 60		1.75~3.0	14~8	1.2	1.7	16	US\$2.67
301-01-011	301-01-012	22IR N 60	22IL N 60	1/2"	3.5~5.0	7~5	1.6	2.4	22	US\$4.50
301-01-013	301-01-014	27IR Q 60	27IL Q 60	5/8"	5.5~6.0	4.5~4	2.3	3.1	27	US\$7.67

PRIAL PROFILE 55°



External

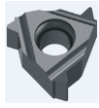

Internal

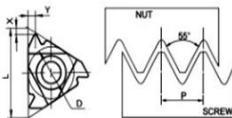

Order No.		Model		D (IC)	Lead&Pitch		Dimensions(mm)			Unit Price
Right hand	Left hand	Right hand	Left hand		mm	TPI	X	Y	L	TiAlN
302-02-001	302-02-002	11ER A 55	11EL A 55	1/4"	0.5~1.5	48~16	0.8	0.9	11	US\$2.67
302-02-003	302-02-004	16ER A 55	16EL A 55	3/8"	0.5~1.5	48~16	0.8	0.9	16	US\$2.67
302-02-005	302-02-006	16ER AG 55	16EL AG 55		0.5~3.0	48~8	1.2	1.7	16	US\$2.67
302-02-007	302-02-008	16ER G 55	16EL G 55		1.75~3.0	14~8	1.2	1.7	16	US\$2.67
302-02-009	302-02-010	22ER N 55	22EL N 55	1/2"	3.5~5.0	7~5	1.7	2.5	22	US\$4.50
302-02-011	302-02-012	27ER Q 55	27EL Q 55	5/8"	5.5-6.0	4.5-4	2	2.9	27	US\$7.67

Internal

Order No.		Model		D (IC)	Lead&Pitch		Dimensions(mm)			Unit Price
Right hand	Left hand	Right hand	Left hand		mm	TPI	X	Y	L	TiAlN
301-02-001	301-02-002	08IR A 55	08IL A 55	3/16"	0.5~1.5	48~16	0.6	0.7	8	US\$3.83
301-02-003	301-02-004	11IR A 55	11IL A 55	1/4"	0.5~1.5	48~16	0.8	0.9	11	US\$2.67
301-02-005	301-02-006	16IR A 55	16IL A 55	3/8"	0.5~1.5	48~16	0.8	0.9	16	US\$2.67
301-02-007	301-02-008	16IR AG 55	16IL AG 55		0.5~3.0	48~8	1.2	1.7	16	US\$2.67
301-02-009	301-02-010	16IR G 55	16IL G 55		1.75~3.0	14~8	1.2	1.7	16	US\$2.67
301-02-011	301-02-012	22IR N 55	22IL N 55	1/2"	3.5~5.0	7~5	1.7	2.5	22	US\$4.50
301-02-013	301-02-014	27IR Q 55	27IL Q 55	5/8"	5.5-6.0	4.5-4	2.0	2.9	27	US\$7.67

ISO METRIC FULL PROFILE

According to standard ISO965-1,DIN13



External



Internal

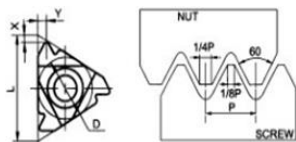

Order No.		Model		D (IC)	Pitch P(mm)	Dimensions(mm)			Unit Price
Right hand	Left hand	Right hand	Left hand			X	Y	L	TiAIN
302-03-005	302-03-006	11ER 0.80ISO	11EL 0.80ISO		0.8	0.6	0.6	11	US\$2.67
302-03-007	302-03-008	11ER 1.00ISO	11EL 1.00ISO		1.0	0.6	0.7	11	US\$2.67
302-03-009	302-03-010	11ER 1.25ISO	11EL 1.25ISO		1.25	0.6	0.9	11	US\$2.67
302-03-011	302-03-012	11ER 1.50ISO	11EL 1.50ISO		1.5	0.6	1.0	11	US\$2.67
302-03-013	302-03-014	16ER 0.50ISO	16EL 0.50ISO	3/8"	0.5	0.6	0.6	16	US\$2.67
302-03-015	302-03-016	16ER 0.75ISO	16EL 0.75ISO		0.75	0.6	0.6	16	US\$2.67
302-03-017	302-03-018	16ER 1.00ISO	16EL 1.00ISO		1.0	0.7	0.7	16	US\$2.67
302-03-019	302-03-020	16ER 1.25ISO	16EL 1.25ISO		1.25	0.8	0.9	16	US\$2.67
302-03-021	302-03-022	16ER 1.50ISO	16EL 1.50ISO		1.50	0.8	1.0	16	US\$2.67
302-03-023	302-03-024	16ER 1.75ISO	16EL 1.75ISO		1.75	0.9	1.2	16	US\$2.67
302-03-025	302-03-026	16ER 2.00ISO	16EL 2.00ISO		2.0	1.0	1.3	16	US\$2.67
302-03-027	302-03-028	16ER 2.50ISO	16EL 2.50ISO		2.5	1.1	1.5	16	US\$2.67
302-03-029	302-03-030	16ER 3.00ISO	16EL 3.00ISO		3.0	1.2	1.6	16	US\$2.67
302-03-031	302-03-032	22ER 3.50ISO	22EL 3.50ISO		1/2"	3.5	1.6	2.3	22
302-03-033	302-03-034	22ER 4.00ISO	22EL 4.00ISO	4.0		1.6	2.3	22	US\$4.50
302-03-035	302-03-036	22ER 4.50ISO	22EL 4.50ISO	4.5		1.7	2.4	22	US\$4.50
302-03-037	302-03-038	22ER 5.00ISO	22EL 5.00ISO	5.0		1.7	2.5	22	US\$4.50
302-03-039	302-03-040	27ER 5.50ISO	27EL 5.50ISO	5/8"	5.5	1.9	2.7	27	US\$7.67
302-03-041	302-03-042	27ER 6.00ISO	27EL 6.00ISO		6.0	2.0	2.9	27	US\$7.67

Internal

Order No.		Model		D (IC)	Pitch P(mm)	Dimensions(mm)			Unit Price
Right hand	Left hand	Right hand	Left hand			X	Y	L	TiAIN
301-03-001	301-03-002	11IR 0.50ISO	11IL 0.50ISO	1/4"	0.50	0.6	0.6	11	US\$2.67
301-03-003	301-03-004	11IR 0.75ISO	11IL 0.75ISO		0.75	0.6	0.6	11	US\$2.67
301-03-005	301-03-006	11IR 1.00ISO	11IL 1.00ISO		1.00	0.6	0.6	11	US\$2.67
301-03-007	301-03-008	11IR 1.25ISO	11IL 1.25ISO		1.25	0.7	0.7	11	US\$2.67
301-03-009	301-03-010	11IR 1.50ISO	11IL 1.50ISO		1.50	0.8	0.9	11	US\$2.67
301-03-011	301-03-012	11IR 1.75ISO	11IL 1.75ISO		1.75	0.8	1.0	11	US\$2.67
301-03-013	301-03-014	11IR 2.00 ISO	11IL 2.00 ISO		2.00	0.9	1.2	11	US\$2.67
301-03-015	301-03-016	16IR 0.50ISO	16IL 0.50ISO	3/8"	0.50	1.0	1.3	16	US\$2.67
301-03-017	301-03-018	16IR 0.75ISO	16IL 0.75ISO		0.75	0.6	0.6	16	US\$2.67
301-03-019	301-03-020	16IR 1.00ISO	16IL 1.00ISO		1.00	0.7	0.7	16	US\$2.67
301-03-021	301-03-022	16IR 1.25ISO	16IL 1.25ISO		1.25	0.8	0.9	16	US\$2.67
301-03-023	301-03-024	16IR 1.50ISO	16IL 1.50ISO		1.50	0.8	1.0	16	US\$2.67
301-03-025	301-03-026	16IR 1.75ISO	16IL 1.75ISO		1.75	0.9	1.2	16	US\$2.67
301-03-027	301-03-028	16IR 2.00ISO	16IL 2.00ISO		2.00	1.0	1.3	16	US\$2.67
301-03-029	301-03-030	16IR 2.50ISO	16IL 2.50ISO	2.50	1.1	1.5	16	US\$2.67	
301-03-031	301-03-032	16IR 3.00ISO	16IL 3.00ISO	3.00	1.1	1.5	16	US\$2.67	
301-03-033	301-03-034	22IR 3.50ISO	22IL 3.50ISO	1/2"	3.50	1.6	2.3	22	US\$4.50
301-03-035	301-03-036	22IR 4.00ISO	22IL 4.00ISO		4.00	1.6	2.3	22	US\$4.50
301-03-037	301-03-038	22IR 4.50ISO	22IL 4.50ISO		4.50	1.6	2.4	22	US\$4.50
301-03-039	301-03-040	22IR 5.00ISO	22IL 5.00ISO		5.00	1.6	2.5	22	US\$4.50
301-03-041	301-03-042	27IR 5.50ISO	27IL 5.50ISO	5/8"	5.50	1.6	2.3	27	US\$7.67
301-03-043	301-03-044	27IR 6.00ISO	27IL 6.00ISO		6.00	1.8	2.5	27	US\$7.67

AMERICAN UN FULL PROFILE

According to standard ANSI B1.1-1983



External



Internal

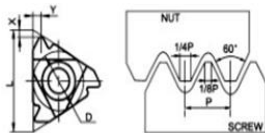

Order No.		Model		D (IC)	Pitch P(TPI)	Dimensions(mm)			Unit Price
Right hand	Left hand	Right hand	Left hand			X	Y	L	TiAIN
302-04-001	302-04-002	11ER 32UN	11EL 32UN	1/4"	32	0.6	0.6	11	US\$2.67
302-04-003	302-04-004	11ER 28UN	11EL 28UN		28	0.6	0.7	11	US\$2.67
302-04-005	302-04-006	11ER 24UN	11EL 24UN		24	0.7	0.8	11	US\$2.67
302-04-007	302-04-008	11ER 20UN	11EL 20UN		20	0.8	0.9	11	US\$2.67
302-04-009	302-04-010	11ER 18UN	11EL 18UN		18	0.8	1.0	11	US\$2.67
302-04-011	302-04-012	11ER 16UN	11EL 16UN		16	0.9	1.1	11	US\$2.67
302-04-013	302-04-014	16ER 32UN	16EL 32UN	3/8"	32	0.6	0.6	16	US\$2.67
302-04-015	302-04-016	16ER 28UN	16EL 28UN		28	0.6	0.7	16	US\$2.67
302-04-017	302-04-018	16ER 24UN	16EL 24UN		24	0.7	0.8	16	US\$2.67
302-04-019	302-04-020	16ER 20UN	16EL 20UN		20	0.8	0.9	16	US\$2.67
302-04-021	302-04-022	16ER 18UN	16EL 18UN		18	0.8	1.0	16	US\$2.67
302-04-023	302-04-024	16ER 16UN	16EL 16UN		16	0.9	1.1	16	US\$2.67
302-04-025	302-04-026	16ER 14UN	16EL 14UN		14	1.0	1.2	16	US\$2.67
302-04-027	302-04-028	16ER 12UN	16EL 12UN		12	1.1	1.4	16	US\$2.67
302-04-029	302-04-030	16ER 11UN	16EL 11UN		11	1.1	1.5	16	US\$2.67
302-04-031	302-04-032	16ER 10UN	16EL 10UN		10	1.2	1.5	16	US\$2.67
302-04-033	302-04-034	16ER 9UN	16EL 9UN		9	1.2	1.7	16	US\$2.67
302-04-035	302-04-036	16ER 8UN	16EL 8UN		8	1.2	2.0	16	US\$2.67
302-04-037	302-04-038	22ER 7UN	22EL 7UN	1/2"	7	1.6	2.3	22	US\$4.50
302-04-039	302-04-040	22ER 6UN	22EL 6UN		6	1.6	2.3	22	US\$4.50
302-04-041	302-04-042	22ER 5UN	22EL 5UN		5	1.7	2.5	22	US\$4.50
302-04-043	302-04-044	27ER 4.5UN	27EL 4.5UN	5/8"	4.5	1.9	2.7	27	US\$7.67
302-04-045	302-04-046	27ER 4UN	27EL 4UN		4	2.1	3.0	27	US\$7.67



Internal

Order No.		Model		D (IC)	Pitch P(TPI)	Dimensions(mm)			Unit Price
Right hand	Left hand	Right hand	Left hand			X	Y	L	TiAIN
301-04-001	301-04-002	08IR 32UN	08IL 32UN	3/16"	32	0.6	0.5	8	US\$3.83
301-04-003	301-04-004	08IR 28UN	08IL 28UN		28	0.6	0.6	8	US\$3.83
301-04-005	301-04-006	08IR 24UN	08IL 24UN		24	0.6	0.6	8	US\$3.83
301-04-007	301-04-008	08IR 20UN	08IL 20UN		20	0.6	0.7	8	US\$3.83
301-04-009	301-04-010	08IR 18UN	08IL 18UN		18	0.6	0.7	8	US\$3.83
301-04-011	301-04-012	08IR 16UN	08IL 16UN		16	0.6	0.7	8	US\$3.83
301-04-013	301-04-014	11IR 32UN	11IL 32UN	1/4"	32	0.6	0.6	11	US\$2.67
301-04-015	301-04-016	11IR 28UN	11IL 28UN		28	0.6	0.7	11	US\$2.67
301-04-017	301-04-018	11IR 24UN	11IL 24UN		24	0.7	0.8	11	US\$2.67
301-04-019	301-04-020	11IR 20UN	11IL 20UN		20	0.8	0.9	11	US\$2.67
301-04-021	301-04-022	11IR 18UN	11IL 18UN		18	0.8	1.0	11	US\$2.67
301-04-023	301-04-024	11IR 16UN	11IL 16UN		16	0.9	1.1	11	US\$2.67
301-04-025	301-04-026	16IR 32UN	16IL 32UN	3/8"	32	0.6	0.6	16	US\$2.67
301-04-027	301-04-028	16IR 28UN	16IL 28UN		28	0.6	0.7	16	US\$2.67
301-04-029	301-04-030	16IR 24UN	16IL 24UN		24	0.7	0.8	16	US\$2.67
301-04-031	301-04-032	16IR 20UN	16IL 20UN		20	0.8	0.9	16	US\$2.67
301-04-033	301-04-034	16IR 18UN	16IL 18UN		18	0.8	1.0	16	US\$2.67
301-04-035	301-04-036	16IR 16UN	16IL 16UN		16	0.9	1.1	16	US\$2.67
301-04-037	301-04-038	16IR 14UN	16IL 14UN		14	1.0	1.2	16	US\$2.67
301-04-039	301-04-040	16IR 12UN	16IL 12UN		12	1.1	1.4	16	US\$2.67
301-04-041	301-04-042	16IR 11UN	16IL 11UN		11	1.1	1.5	16	US\$2.67
301-04-043	301-04-044	16IR 10UN	16IL 10UN		10	1.1	1.5	16	US\$2.67
301-04-045	301-04-046	16IR 9UN	16IL 9UN		9	1.2	1.7	16	US\$2.67
301-04-047	301-04-048	16IR 8UN	16IL 8UN		8	1.2	1.5	16	US\$2.67
301-04-049	301-04-050	22IR 7UN	22IL 7UN	1/2"	7	1.6	2.3	22	US\$4.50
301-04-051	301-04-052	22IR 6UN	22IL 6UN		6	1.6	2.3	22	US\$4.50
301-04-053	301-04-054	22IR 5UN	22IL 5UN		5	1.7	2.3	22	US\$4.50
301-04-055	301-04-056	27IR 4.5UN	27IL 4.5UN	5/8"	4.5	1.9	2.4	27	US\$7.67
301-04-057	301-04-058	27IR 4UN	27IL 4UN		4	2.1	2.7	27	US\$7.67

AMERICAN TAPER PIPE FULL PROFILE

According to standard ANSI/ASME B 1.20.1-1983



External



Internal

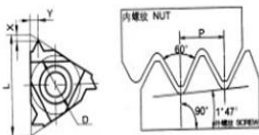

Order No.		Model		D (IC)	Pitch P(TPI)	Dimensions(mm)			Unit Price
Right hand	Left hand	Right hand	Left hand			X	Y	L	TiAIN
302-05-001	302-05-002	11ER 27NPT	11EL 27NPT	1/4"	27	0.7	0.8	11	US\$2.67
302-05-003	302-05-004	11ER 18NPT	11EL 18NPT		18	0.8	1.0	11	US\$2.67
302-05-005	302-05-006	11ER 14NPT	11EL 14NPT		14	0.8	1.0	11	US\$2.67
302-05-007	302-05-008	16ER 27NPT	16EL 27NPT	3/8"	27	0.7	0.8	16	US\$2.67
302-05-009	302-05-010	16ER 18NPT	16EL 18NPT		18	0.8	1.0	16	US\$2.67
302-05-011	302-05-012	16ER 14NPT	16EL 14NPT		14	0.9	1.2	16	US\$2.67
302-05-013	302-05-014	16ER 11.5NPT	16EL 11.5NPT		11.5	1.1	1.5	16	US\$2.67
302-05-015	302-05-016	16ER 8NPT	16EL 8NPT		8	1.3	1.8	16	US\$2.67

Internal

Order No.		Model		D (IC)	Pitch P(TPI)	Dimensions(mm)			Unit Price
Right hand	Left hand	Right hand	Left hand			X	Y	L	TiAIN
301-05-001	301-05-002	08IR 27NPT	08IL 27NPT	3/16"	27	0.6	0.6	8	US\$3.83
301-05-003	301-05-004	08IR 18NPT	08IL 18NPT		18	0.6	0.6	8	US\$3.83
301-05-005	301-05-006	11IR 27NPT	11IL 27NPT	1/4"	27	0.7	0.8	11	US\$2.67
301-05-007	301-05-008	11IR 18NPT	11IL 18NPT		18	0.8	1.0	11	US\$2.67
301-05-009	301-05-010	11IR 14NPT	11IL 14NPT		14	0.8	1.0	11	US\$2.67
301-05-011	301-05-012	16IR 27NPT	16IL 27NPT	3/8"	27	0.7	0.8	16	US\$2.67
301-05-013	301-05-014	16IR 18NPT	16IL 18NPT		18	0.8	1.0	16	US\$2.67
301-05-015	301-05-016	16IR 14NPT	16IL 14NPT		14	0.9	1.2	16	US\$2.67
301-05-017	301-05-018	16IR 11.5NPT	16IL 11.5NPT		11.5	1.1	1.5	16	US\$2.67
301-05-019	301-05-020	16IR 8NPT	16IL 8NPT		8	1.3	1.8	16	US\$2.67

AMERICAN DRYSEAL TAPER PIPE FULL PROFILE

According to standard ANSI B1.20.3-1976

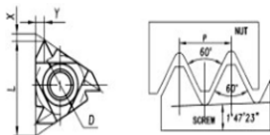
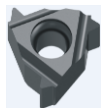

External

Internal

Order No.		Model		D (IC)	Pitch P(TPI)	Dimensions(mm)			Unit Price TiAIN
Right hand	Left hand	Right hand	Left hand			X	Y	L	
302-06-001	302-06-002	11ER 27NPTF	11EL 27NPTF	1/4"	27	0.7	0.7	11	US\$2.67
302-06-003	302-06-004	11ER 18NPTF	11EL 18NPTF		18	0.8	1.0	11	US\$2.67
302-06-005	302-06-006	11ER 14NPTF	11EL 14NPTF		14	0.8	1.0	11	US\$2.67
302-06-007	302-06-008	16ER 27NPTF	16EL 27NPTF	3/8"	27	0.7	0.7	16	US\$2.67
302-06-009	302-06-010	16ER 18NPTF	16EL 18NPTF		18	0.8	1.0	16	US\$2.67
302-06-011	302-06-012	16ER 14NPTF	16EL 14NPTF		14	0.9	1.2	16	US\$2.67
302-06-013	302-06-014	16ER 11.5NPTF	16EL 11.5NPTF		11.5	1.1	1.5	16	US\$2.67
302-06-015	302-06-016	16ER 8NPTF	16EL 8NPTF		8	1.5	1.8	16	US\$2.67

Internal

Order No.		Model		D (IC)	Pitch P(TPI)	Dimensions(mm)			Unit Price TiAIN
Right hand	Left hand	Right hand	Left hand			X	Y	L	
301-06-001	301-06-002	08IR 27NPTF	08IL 27NPTF	3/16"	27	0.7	0.7	8	US\$3.83
301-06-003	301-06-004	08IR 18NPTF	08IL 18NPTF		18	0.8	1.0	8	US\$3.83
301-06-005	301-06-006	11IR 27NPTF	11IL 27NPTF	1/4"	27	0.7	0.7	11	US\$2.67
301-06-007	301-06-008	11IR 18NPTF	11IL 18NPTF		18	0.8	1.0	11	US\$2.67
301-06-009	301-06-010	11IR 14NPTF	11IL 14NPTF		14	0.8	1.0	11	US\$2.67
301-06-011	301-06-012	16IR 27NPTF	16IL 27NPTF	3/8"	27	0.7	0.7	16	US\$2.67
301-06-013	301-06-014	16IR 18NPTF	16IL 18NPTF		18	0.8	1.0	16	US\$2.67
301-06-015	301-06-016	16IR 14NPTF	16IL 14NPTF		14	0.9	1.2	16	US\$2.67
301-06-017	301-06-018	16IR 11.5NPTF	16IL 11.5NPTF		11.5	1.1	1.5	16	US\$2.67
301-06-019	301-06-020	16IR 8NPTF	16IL 8NPTF		8	1.5	1.8	16	US\$2.67

BRITISH STANDARD TAPER PIPE FULL PROFILE

According to standard B.S.21:1985



External



Internal

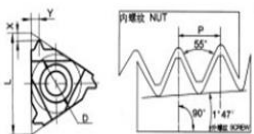

Order No.		Model		D (IC)	Pitch P(TPI)	Dimensions(mm)			Unit Price
Right hand	Left hand	Right hand	Left hand			X	Y	L	TiAIN
302-07-001	302-07-002	11ER 28BSPT	11EL 28BSPT	1/4"	28	0.6	0.6	11	US\$2.67
302-07-003	302-07-004	11ER 19BSPT	11EL 19BSPT		19	0.8	0.9	11	US\$2.67
302-07-005	302-07-006	11ER 14BSPT	11EL 14BSPT		14	0.9	1.0	11	US\$2.67
302-07-007	302-07-008	16ER 28BSPT	16EL 28BSPT	3/8"	28	0.6	0.6	16	US\$2.67
302-07-009	302-07-010	16ER 19BSPT	16EL 19BSPT		19	0.8	0.9	16	US\$2.67
302-07-011	302-07-012	16ER 14BSPT	16EL 14BSPT		14	1.0	1.2	16	US\$2.67
302-07-013	302-07-014	16ER 11BSPT	16EL 11BSPT		11	1.1	1.5	16	US\$2.67

Internal

Order No.		Model		D (IC)	Pitch P(TPI)	Dimensions(mm)			Unit Price
Right hand	Left hand	Right hand	Left hand			X	Y	L	TiAIN
301-07-001	301-07-002	11IR 28BSPT	11IL 28BSPT	1/4"	28	0.6	0.6	11	US\$2.67
301-07-003	301-07-004	11IR 19BSPT	11IL 19BSPT		19	0.8	0.9	11	US\$2.67
301-07-005	301-07-006	11IR 14BSPT	11IL 14BSPT		14	0.9	1.0	11	US\$2.67
301-07-007	301-07-008	16IR 28BSPT	16IL 28BSPT	3/8"	28	0.6	0.6	16	US\$2.67
301-07-009	301-07-010	16IR 19BSPT	16IL 19BSPT		19	0.8	0.9	16	US\$2.67
301-07-011	301-07-012	16IR 14BSPT	16IL 14BSPT		14	1.0	1.2	16	US\$2.67
301-07-013	301-07-014	16IR 11BSPT	16IL 11BSPT		11	1.1	1.5	16	US\$2.67

55° WHITWORTH FULL PROFILE

According to standard B.S.84:1956,ISO228-1982

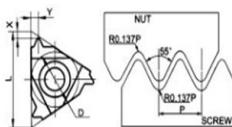

External

Order No.		Model		D (IC)	Pitch P(TPI)	Dimensions(mm)			Unit Price
Right hand	Left hand	Right hand	Left hand			X	Y	L	TiAIN
302-08-001	302-08-002	11ER 28W	11EL 28W	1/4"	28	0.6	0.6	11	US\$2.67
302-08-003	302-08-004	11ER 26W	11EL 26W		28	0.6	0.7	11	US\$2.67
302-08-005	302-08-006	11ER 20W	11EL 20W		24	0.7	0.8	11	US\$2.67
302-08-007	302-08-008	11ER 19W	11EL 19W		20	0.8	0.9	11	US\$2.67
302-08-009	302-08-010	11ER 16W	11EL 16W		16	0.9	1.1	11	US\$2.67
302-08-011	302-08-012	11ER 14W	11EL 14W		32	0.6	0.6	11	US\$2.67
302-08-013	302-08-014	16ER 28W	16EL 28W	3/8"	28	0.6	0.7	16	US\$2.67
302-08-015	302-08-016	16ER 26W	16EL 26W		26	0.7	0.8	16	US\$2.67
302-08-017	302-08-018	16ER 20W	16EL 20W		20	0.8	0.9	16	US\$2.67
302-08-019	302-08-020	16ER 19W	16EL 19W		19	0.8	1.0	16	US\$2.67
302-08-021	302-08-022	16ER 14W	16EL 14W		14	1.0	1.2	16	US\$2.67
302-08-023	302-08-024	16ER 12W	16EL 12W		12	1.1	1.4	16	US\$2.67
302-08-025	302-08-026	16ER 11W	16EL 11W		11	1.1	1.5	16	US\$2.67
302-08-027	302-08-028	16ER 10W	16EL 10W		10	1.2	1.5	16	US\$2.67
302-08-029	302-08-030	16ER 9W	16EL 9W		9	1.2	1.7	16	US\$2.67
302-08-031	302-08-032	16ER 8W	16EL 8W		8	1.2	2.0	16	US\$2.67
302-08-033	302-08-034	22ER 7W	22EL 7W	1/2"	7	1.6	2.3	22	US\$4.50
302-08-035	302-08-036	22ER 6W	22EL 6W		6	1.6	2.3	22	US\$4.50
302-08-037	302-08-038	22ER 5W	22EL 5W		5	1.7	2.5	22	US\$4.50
302-08-039	302-08-040	27ER 4.5W	27EL 4.5W	5/8"	4.5	1.9	2.7	27	US\$7.67
302-08-041	302-08-042	27ER 4W	27EL 4W		4	2.1	3.0	27	US\$7.67

Internal

Order No.		Model		D (IC)	Pitch P(TPI)	Dimensions(mm)			Unit Price
Right hand	Left hand	Right hand	Left hand			X	Y	L	TiAIN
301-08-001	301-08-002	08IR 28W	08IL 28W	3/16"	28	0.6	0.6	8	US\$3.83
301-08-003	301-08-004	08IR 26W	08IL 26W		26	0.6	0.6	8	US\$3.83
301-08-005	301-08-006	08IR 24W	08IL 24W		24	0.6	0.7	8	US\$3.83
301-08-007	301-08-008	08IR 20W	08IL 20W		20	0.6	0.7	8	US\$3.83
301-08-009	301-08-010	08IR 19W	08IL 19W		19	0.6	0.7	8	US\$3.83
301-08-011	301-08-012	08IR 16W	08IL 16W		16	0.6	0.7	8	US\$3.83
301-08-013	301-08-014	11IR 28W	11IL 28W	1/4"	28	0.6	0.6	11	US\$2.67
301-08-015	301-08-016	11IR 26W	11IL 26W		28	0.6	0.7	11	US\$2.67
301-08-017	301-08-018	11IR 20W	11IL 20W		24	0.7	0.8	11	US\$2.67
301-08-019	301-08-020	11IR 19W	11IL 19W		20	0.8	0.9	11	US\$2.67
301-08-021	301-08-022	11IR 16W	11IL 16W		16	0.9	1.1	11	US\$2.67
301-08-023	301-08-024	11IR 14W	11IL 14W		32	0.6	0.6	11	US\$2.67
301-08-025	301-08-026	16IR 28W	16IL 28W	3/8"	28	0.6	0.7	16	US\$2.67
301-08-027	301-08-028	16IR 26W	16IL 26W		26	0.7	0.8	16	US\$2.67
301-08-029	301-08-030	16IR 20W	16IL 20W		20	0.8	0.9	16	US\$2.67
301-08-031	301-08-032	16IR 19W	16IL 19W		19	0.8	1.0	16	US\$2.67
301-08-033	301-08-034	16IR 14W	16IL 14W		14	1.0	1.2	16	US\$2.67
301-08-035	301-08-036	16IR 12W	16IL 12W		12	1.1	1.4	16	US\$2.67
301-08-037	301-08-038	16IR 11W	16IL 11W		11	1.1	1.5	16	US\$2.67
301-08-039	301-08-040	16IR 10W	16IL 10W		10	1.2	1.5	16	US\$2.67
301-08-041	301-08-042	16IR 9W	16IL 9W		9	1.2	1.7	16	US\$2.67
301-08-043	301-08-044	16IR 8W	16IL 8W		8	1.2	2.0	16	US\$2.67
301-08-045	301-08-046	22IR 7W	22IL 7W	1/2"	7	1.6	2.3	22	US\$4.50
301-08-047	301-08-048	22IR 6W	22IL 6W		6	1.6	2.3	22	US\$4.50
301-08-049	301-08-050	22IR 5W	22IL 5W		5	1.7	2.5	22	US\$4.50
301-08-051	301-08-052	27IR 4.5W	27IL 4.5W	5/8"	4.5	1.9	2.7	27	US\$7.67
301-08-053	301-08-054	27IR 4W	27IL 4W		4	2.1	3.0	27	US\$7.67

INCH SIZE TRAPEZE ACME

According to standard ANSI/ASME 1.5-1988



External

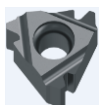

Internal

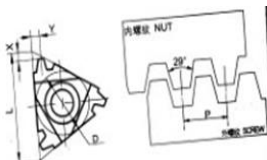

Order No.		Model		D (IC)	Pitch P(TPI)	Dimensions(mm)			Unit Price
Right hand	Left hand	Right hand	Left hand			X	Y	L	TiAIN
302-09-001	302-09-002	16ER 16ACME	16EL 16ACME	3/8"	16	1	1.1	16	US\$2.67
302-09-003	302-09-004	16ER 14ACME	16EL 14ACME		14	1.0	1.2	16	US\$2.67
302-09-005	302-09-006	16ER 12ACME	16EL 12ACME		12	1.1	1.2	16	US\$2.67
302-09-007	302-09-008	16ER 10ACME	16EL 10ACME		10	1.3	1.4	16	US\$2.67
302-09-009	302-09-010	16ER 8ACME	16EL 8ACME		8	1.4	1.5	16	US\$2.67
302-09-011	302-09-012	22ER 6ACME	22EL 6ACME	1/2"	6	1.7	1.9	22	US\$4.50
302-09-013	302-09-014	22ER 5ACME	22EL 5ACME	5/8"	5	1.8	2.1	22	US\$4.50
302-09-015	302-09-016	27ER 4ACME	27EL 4ACME		4	2.0	2.3	27	US\$7.67

Internal

Order No.		Model		D (IC)	Pitch P(TPI)	Dimensions(mm)			Unit Price
Right hand	Left hand	Right hand	Left hand			X	Y	L	TiAIN
301-09-001	301-09-002	16IR 16ACME	16IL 16ACME	3/8"	16	1	1.1	16	US\$2.67
301-09-003	301-09-004	16IR 14ACME	16IL 14ACME		14	1.0	1.2	16	US\$2.67
301-09-005	301-09-006	16IR 12ACME	16IL 12ACME		12	1.1	1.2	16	US\$2.67
301-09-007	301-09-008	16IR 10ACME	16IL 10ACME		10	1.3	1.4	16	US\$2.67
301-09-009	301-09-010	16IR 8ACME	16IL 8ACME		8	1.4	1.5	16	US\$2.67
301-09-011	301-09-012	22IR 6ACME	22IL 6ACME	1/2"	6	1.7	1.9	22	US\$4.50
301-09-013	301-09-014	22IR 5ACME	22IL 5ACME	5/8"	5	1.8	2.1	22	US\$4.50
301-09-015	301-09-016	27IR 4ACME	27IL 4ACME		4	2.0	2.3	27	US\$7.67

METRIC SIZE TRAPEZE TR

According to standard DIN103-1977



External



Internal

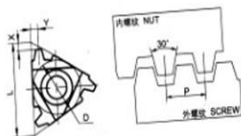

Order No.		Model		D (IC)	Pitch P(mm)	Dimensions(mm)			Unit Price
Right hand	Left hand	Right hand	Left hand			X	Y	L	TiAIN
302-10-001	302-10-002	11ER 1.50TR	11EL 1.50TR	1/4"	1.5	0.8	0.9	11	US\$2.67
302-10-003	302-10-004	16ER 1.50TR	16EL 1.50TR	3/8"	1.5	1.0	1.1	16	US\$2.67
302-10-005	302-10-006	16ER 2.00TR	16EL 2.00TR		2.0	1.1	1.3	16	US\$2.67
302-10-007	302-10-008	16ER 2.50TR	16EL 2.50TR		2.5	1.2	1.4	16	US\$2.67
302-10-009	302-10-010	16ER 3.00TR	16EL 3.00TR		3.0	1.3	1.5	16	US\$2.67
302-10-011	302-10-012	22ER 4.00 TR	22EL 4.00 TR	1/2"	4.0	1.7	1.9	22	US\$4.50
302-10-013	302-10-014	22ER 5.00TR	22EL 5.00TR		5.0	2.1	2.5	22	US\$4.50
302-10-015	302-10-016	22ER 6.00TR	22EL 6.00TR		6.0	2.3	2.7	22	US\$4.50
302-10-017	302-10-018	27ER 6.00TR	27EL 6.00TR	5/8"	6.0	2.3	2.7	27	US\$7.67
302-10-019	302-10-020	27ER 7.00TR	27EL 7.00TR		7.0	2.2	2.6	27	US\$7.67

Internal

Order No.		Model		D (IC)	Pitch P(mm)	Dimensions(mm)			Unit Price
Right hand	Left hand	Right hand	Left hand			X	Y	L	TiAIN
301-10-001	301-10-002	11IR 1.50TR	11IL 1.50TR	1/4"	1.5	0.8	0.9	11	US\$2.67
301-10-003	301-10-004	16IR 1.50TR	16IL 1.50TR	3/8"	1.5	1.0	1.1	16	US\$2.67
301-10-005	301-10-006	16IR 2.00TR	16IL 2.00TR		2.0	1.1	1.3	16	US\$2.67
301-10-007	301-10-008	16IR 2.50TR	16IL 2.50TR		2.5	1.2	1.4	16	US\$2.67
301-10-009	301-10-010	16IR 3.00TR	16IL 3.00TR		3.0	1.3	1.5	16	US\$2.67
301-10-011	301-10-012	22IR 4.00 TR	22IL 4.00 TR	1/2"	4.0	1.7	1.9	22	US\$4.50
301-10-013	301-10-014	22IR 5.00TR	22IL 5.00TR		5.0	2.1	2.5	22	US\$4.50
301-10-015	301-10-016	22IR 6.00TR	22IL 6.00TR		6.0	2.3	2.7	22	US\$4.50
301-10-017	301-10-018	27IR 6.00TR	27IL 6.00TR	5/8"	6.0	2.3	2.7	27	US\$7.67
301-10-019	301-10-020	27IR 7.00TR	27IL 7.00TR		7.0	2.2	2.6	27	US\$7.67

INDEXABLE THREADING MILLS

Used for cutting both internal and external thread.
Shank according to DIN1835B.

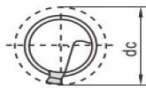
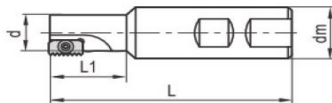

Order No.	Model	Size(mm)					No.of teeth	Insert	Screw	Torx wrench	Weight	Unit Price FOB
		dc	dm	d	L1	L						
241-17-001	SMT-14.5-14	14.5	20	11	25	85	1	14...	C030A07S	T9	0.2	US\$33.30
241-17-002	SMT-17-14	17	20	14	30	85	1	14...	C030A07S	T9	0.3	US\$33.30
241-17-003	SMT-20-14	20	20	17	35	90	1	14...	C030A07S	T9	0.3	US\$33.30
241-17-004	SMT-25-14	25	25	22	40	100	1	14...	C030A07S	T9	0.4	US\$35.10
241-17-005	SMT-18-21	18	20	14	30	85	1	21...	C040A09S	T15	0.3	US\$35.10
241-17-006	SMT-21-21	21	20	17	40	95	1	21...	C040A09S	T15	0.3	US\$35.10
241-17-007	SMT-25-21	25	25	21	50	115	1	21...	C040A09S	T15	0.4	US\$35.10
241-17-008	SMT-29-30	29	25	24	50	115	1	30...	C050A12S	T20	0.6	US\$38.70
241-17-009	SMT-48-40	48	40	40	80	160	1	40...	C050A12S	T20	2.3	US\$46.80

Recommend cutting data

Application	Finish cutting			Medium cutting			rough cutting		
	Surface speed Vc(m/min)	Feed per tooth fz(mm)	Cutting depth ap(mm)	Surface speed Vc(m/min)	Feed per tooth fz(mm)	Cutting depth ap(mm)	Surface speed Vc(m/min)	Feed per tooth fz(mm)	Cutting depth ap(mm)
Steel	-	-	-	140-80	0.05-0.12	-	-	-	-
Stainless Steel	-	-	-	100-60	0.04-0.10	-	-	-	-
Cast iron	-	-	-	100-60	0.05-0.15	-	-	-	-
Non ferrous metal	-	-	-	-	-	-	-	-	-
High temperature alloy	-	-	-	-	-	-	-	-	-

INDEXABLE THREADING CHASER

used for cutting both internal and external thread.

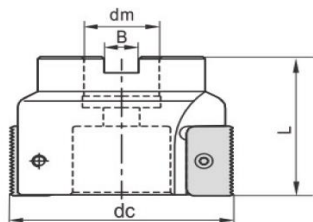

Order No.	Model	Size(mm)				No.of teeth	Insert	Screw	Torx wrench	Weight	Unit Price FOB
		dc	dm	B	L						
231-17-001	SMF-50-14	50	22	10.4	40	5	14...	C030A07S	WT9	0.4	US\$108.00
231-17-002	SMF-63-21	63	22	10.4	50	5	21...	C040A09S	WT15	0.6	US\$108.00
231-17-003	SMF-80-21	80	27	12.4	50	6	21...	C040A09S	WT15	1.1	US\$118.80
231-17-004	SMF-80-30	80	27	12.4	55	4	30...	C050A12S	WT20	1.1	US\$94.50
231-17-005	SMF-100-30	100	32	14.4	60	4	30...	C050A12S	WT20	1.9	US\$99.00
231-17-006	SMF-80-40	80	27	12.4	65	4	40...	C050A12S	WT20	1.1	US\$94.50
231-17-007	SMF-100-40	100	32	14.4	70	4	40...	C050A12S	WT20	1.9	US\$99.00

Inert not included

Recommend cutting data

Application	Finish cutting			Medium cutting			rough cutting		
	Surface speed Vc(m/min)	Feed per tooth fz(mm)	Cutting depth ap(mm)	Surface speed Vc(m/min)	Feed per tooth fz(mm)	Cutting depth ap(mm)	Surface speed Vc(m/min)	Feed per tooth fz(mm)	Cutting depth ap(mm)
Steel	-	-	-	140-80	0.05-0.12	-	-	-	-
Stainless Steel	-	-	-	100-60	0.04-0.10	-	-	-	-
Cast iron	-	-	-	100-60	0.08-0.15	-	-	-	-
Non ferrous metal	-	-	-	-	-	-	-	-	-
High temperature alloy	-	-	-	-	-	-	-	-	-

SOLID CARBIDE ISO METRIC THREAD MILLING INSERTS FOR STEEL

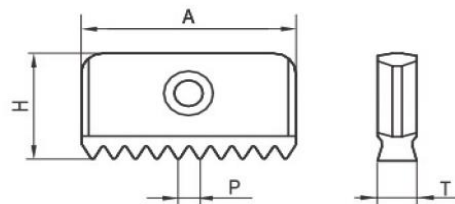

External

Order No.	Model	Pitch P(mm)	Insert size			Grade	Application	Unit Price FOB
			A	H	T			
304-17-001	14E0.75 ISO	0.75	14	7.5	3.1	EP2220	Steel	
304-17-002	14E1.00 ISO	1.00	14	7.5	3.1	EP2220	Steel	US\$9.27
304-17-003	14E1.25 ISO	1.25	14	7.5	3.1	EP2220	Steel	US\$9.27
304-17-004	14E1.50 ISO	1.50	14	7.5	3.1	EP2220	Steel	US\$9.27
304-17-005	14E1.75 ISO	1.75	14	7.5	3.1	EP2220	Steel	US\$9.27
304-17-006	14E2.00 ISO	2.00	14	7.5	3.1	EP2220	Steel	US\$9.27
304-17-007	14E2.50 ISO	2.50	14	7.5	3.1	EP2220	Steel	US\$9.27
304-17-008	21E1.00 ISO	1.00	21	12	4.7	EP2220	Steel	US\$11.97
304-17-009	21E1.50 ISO	1.50	21	12	4.7	EP2220	Steel	US\$11.97
304-17-010	21E2.00 ISO	2.00	21	12	4.7	EP2220	Steel	US\$11.97
304-17-011	21E2.50 ISO	2.50	21	12	4.7	EP2220	Steel	US\$11.97
304-17-012	21E3.00 ISO	3.00	21	12	4.7	EP2220	Steel	US\$11.97
304-17-013	30E1.50 ISO	1.50	30	16	5.5	EP2220	Steel	US\$21.94
304-17-014	30E2.00 ISO	2.00	30	16	5.5	EP2220	Steel	US\$21.94
304-17-015	30E3.00 ISO	3.00	30	16	5.5	EP2220	Steel	US\$21.94
304-17-016	30E3.50 ISO	3.50	30	16	5.5	EP2220	Steel	US\$21.94
304-17-017	30E4.00 ISO	4.00	30	16	5.5	EP2220	Steel	US\$21.94
304-17-018	40E1.50 ISO	1.50	40	20	6.3	EP2220	Steel	US\$43.87
304-17-019	40E2.00 ISO	2.00	40	20	6.3	EP2220	Steel	US\$43.87
304-17-020	40E3.00 ISO	3.00	40	20	6.3	EP2220	Steel	US\$43.87
304-17-021	40E4.00 ISO	4.00	40	20	6.3	EP2220	Steel	US\$43.87
304-17-022	40E5.00 ISO	5.00	40	20	6.3	EP2220	Steel	US\$43.87
304-17-023	40E6.00 ISO	6.00	40	20	6.3	EP2220	Steel	US\$43.87

Internal

Order No.	Model	Pitch P(mm)	Insert size			Grade	Application	Unit Price FOB
			A	H	T			
303-17-004	1411.25 ISO	1.25	14	7.5	3.1	EP2220	Steel	US\$9.27
303-17-005	1411.50 ISO	1.50	14	7.5	3.1	EP2220	Steel	US\$9.27
303-17-006	1411.75 ISO	1.75	14	7.5	3.1	EP2220	Steel	US\$9.27
303-17-007	1412.00 ISO	2.00	14	7.5	3.1	EP2220	Steel	US\$9.27
303-17-008	1412.50 ISO	2.50	14	7.5	3.1	EP2220	Steel	US\$9.27
303-17-009	2111.00 ISO	1.00	21	12	4.7	EP2220	Steel	US\$11.97
303-17-010	2111.50 ISO	1.50	21	12	4.7	EP2220	Steel	US\$11.97
303-17-011	2111.75 ISO	1.75	21	12	4.7	EP2220	Steel	US\$11.97
303-17-012	2112.00 ISO	2.00	21	12	4.7	EP2220	Steel	US\$11.97
303-17-013	2112.50 ISO	2.50	21	12	4.7	EP2220	Steel	US\$11.97
303-17-014	2113.00 ISO	3.00	21	12	4.7	EP2220	Steel	US\$11.97
303-17-015	2113.50 ISO	3.50	21	12	4.7	EP2220	Steel	US\$11.97
303-17-016	3011.50 ISO	1.50	30	16	5.5	EP2220	Steel	US\$21.94
303-17-017	3012.00 ISO	2.00	30	16	5.5	EP2220	Steel	US\$21.94
303-17-018	3013.00 ISO	3.00	30	16	5.5	EP2220	Steel	US\$21.94
303-17-019	3013.50 ISO	3.50	30	16	5.5	EP2220	Steel	US\$21.94
303-17-020	3014.00 ISO	4.00	30	16	5.5	EP2220	Steel	US\$21.94
303-17-021	3014.50 ISO	4.50	30	16	5.5	EP2220	Steel	US\$21.94
303-17-022	4011.50 ISO	1.50	40	20	6.3	EP2220	Steel	US\$43.87
303-17-023	4012.00 ISO	2.00	40	20	6.3	EP2220	Steel	US\$43.87
303-17-024	4013.00 ISO	3.00	40	20	6.3	EP2220	Steel	US\$43.87
303-17-025	4013.50 ISO	3.50	40	20	6.3	EP2220	Steel	US\$43.87
303-17-026	4014.00 ISO	4.00	40	20	6.3	EP2220	Steel	US\$43.87
303-17-027	4014.50 ISO	4.50	40	20	6.3	EP2220	Steel	US\$43.87
303-17-028	4015.00 ISO	5.00	40	20	6.3	EP2220	Steel	US\$43.87
303-17-029	4015.50 ISO	5.50	40	20	6.3	EP2220	Steel	US\$43.87
303-17-030	4016.00 ISO	6.00	40	20	6.3	EP2220	Steel	US\$43.87

SOLID CARBIDE ISO METRIC THREAD MILLING INSERTS FOR STAINLESS STEEL

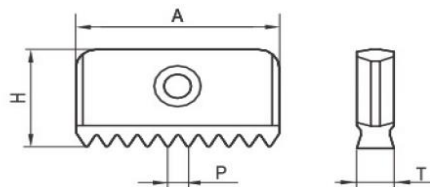

External

Order No.	Model	Pitch P(mm)	Insert size (mm)			Grade	Application	Unit Price FOB
			A	H	T			
306-17-002	14E1.00 ISO	1.00	14	7.5	3.1	EP3220	INOX	US\$9.27
306-17-003	14E1.25 ISO	1.25	14	7.5	3.1	EP3220	INOX	US\$9.27
306-17-004	14E1.50 ISO	1.50	14	7.5	3.1	EP3220	INOX	US\$9.27
306-17-005	14E1.75 ISO	1.75	14	7.5	3.1	EP3220	INOX	US\$9.27
306-17-006	14E2.00 ISO	2.00	14	7.5	3.1	EP3220	INOX	US\$9.27
306-17-007	14E2.50 ISO	2.50	14	7.5	3.1	EP3220	INOX	US\$9.27
306-17-008	21E1.00 ISO	1.00	21	12	4.7	EP3220	INOX	US\$11.97
306-17-009	21E1.50 ISO	1.50	21	12	4.7	EP3220	INOX	US\$11.97
306-17-010	21E2.00 ISO	2.00	21	12	4.7	EP3220	INOX	US\$11.97
306-17-011	21E2.50 ISO	2.50	21	12	4.7	EP3220	INOX	US\$11.97
306-17-012	21E3.00 ISO	3.00	21	12	4.7	EP3220	INOX	US\$11.97
306-17-013	30E1.50 ISO	1.50	30	16	5.5	EP3220	INOX	US\$21.94
306-17-014	30E2.00 ISO	2.00	30	16	5.5	EP3220	INOX	US\$21.94
306-17-015	30E3.00 ISO	3.00	30	16	5.5	EP3220	INOX	US\$21.94
306-17-016	30E3.50 ISO	3.50	30	16	5.5	EP3220	INOX	US\$21.94
306-17-017	30E4.00 ISO	4.00	30	16	5.5	EP3220	INOX	US\$21.94
306-17-018	40E1.50 ISO	1.50	40	20	6.3	EP3220	INOX	US\$43.87
306-17-019	40E2.00 ISO	2.00	40	20	6.3	EP3220	INOX	US\$43.87
306-17-020	40E3.00 ISO	3.00	40	20	6.3	EP3220	INOX	US\$43.87
306-17-021	40E4.00 ISO	4.00	40	20	6.3	EP3220	INOX	US\$43.87
306-17-022	40E5.00 ISO	5.00	40	20	6.3	EP3220	INOX	US\$43.87
306-17-023	40E6.00 ISO	6.00	40	20	6.3	EP3220	INOX	US\$43.87

Internal

Order No.	Model	Pitch P(mm)	Insert size			Grade	Application	Unit Price FOB
			A	H	T			
305-17-001	1410.50 ISO	0.50	14	7.5	3.1	EP3220	INOX	US\$9.27
305-17-002	1410.75 ISO	0.75	14	7.5	3.1	EP3220	INOX	US\$9.27
305-17-003	1411.00 ISO	1.00	14	7.5	3.1	EP3220	INOX	US\$9.27
305-17-004	1411.25 ISO	1.25	14	7.5	3.1	EP3220	INOX	US\$9.27
305-17-005	1411.50 ISO	1.50	14	7.5	3.1	EP3220	INOX	US\$9.27
305-17-006	1411.75 ISO	1.75	14	7.5	3.1	EP3220	INOX	US\$9.27
305-17-007	1412.00 ISO	2.00	14	7.5	3.1	EP3220	INOX	US\$9.27
305-17-008	1412.50 ISO	2.50	14	7.5	3.1	EP3220	INOX	US\$9.27
305-17-009	2111.00 ISO	1.00	21	12	4.7	EP3220	INOX	US\$11.97
305-17-010	2111.50 ISO	1.50	21	12	4.7	EP3220	INOX	US\$11.97
305-17-011	2111.75 ISO	1.75	21	12	4.7	EP3220	INOX	US\$11.97
305-17-012	2112.00 ISO	2.00	21	12	4.7	EP3220	INOX	US\$11.97
305-17-013	2112.50 ISO	2.50	21	12	4.7	EP3220	INOX	US\$11.97
305-17-014	2113.00 ISO	3.00	21	12	4.7	EP3220	INOX	US\$11.97
305-17-015	2113.50 ISO	3.50	21	12	4.7	EP3220	INOX	US\$11.97
305-17-016	3011.50 ISO	1.50	30	16	5.5	EP3220	INOX	US\$21.94
305-17-017	3012.00 ISO	2.00	30	16	5.5	EP3220	INOX	US\$21.94
305-17-018	3013.00 ISO	3.00	30	16	5.5	EP3220	INOX	US\$21.94
305-17-019	3013.50 ISO	3.50	30	16	5.5	EP3220	INOX	US\$21.94
305-17-020	3014.00 ISO	4.00	30	16	5.5	EP3220	INOX	US\$21.94
305-17-021	3014.50 ISO	4.50	30	16	5.5	EP3220	INOX	US\$21.94
305-17-022	4011.50 ISO	1.50	40	20	6.3	EP3220	INOX	US\$43.87
305-17-023	4012.00 ISO	2.00	40	20	6.3	EP3220	INOX	US\$43.87
305-17-024	4013.00 ISO	3.00	40	20	6.3	EP3220	INOX	US\$43.87
305-17-025	4013.50 ISO	3.50	40	20	6.3	EP3220	INOX	US\$43.87
305-17-026	4014.00 ISO	4.00	40	20	6.3	EP3220	INOX	US\$43.87
305-17-027	4014.50 ISO	4.50	40	20	6.3	EP3220	INOX	US\$43.87
305-17-028	4015.00 ISO	5.00	40	20	6.3	EP3220	INOX	US\$43.87
305-17-029	4015.50 ISO	5.50	40	20	6.3	EP3220	INOX	US\$43.87
305-17-030	4016.00 ISO	6.00	40	20	6.3	EP3220	INOX	US\$43.87

SOLID CARBIDE ISO METRIC THREAD MILLING INSERTS FOR CAST IRON

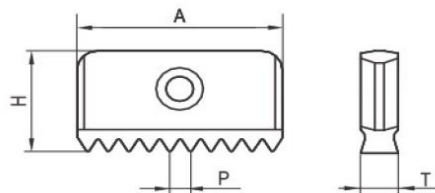



External

Order No.	Model	Pitch P(mm)	Insert size			Grade	Application	Unit Price FOB
			A	H	T			
308-17-001	14E0.75 ISO	0.75	14	7.5	3.1	EP3220	Cast Iron	
308-17-002	14E1.00 ISO	1.00	14	7.5	3.1	EP3220	Cast Iron	US\$9.27
308-17-003	14E1.25 ISO	1.25	14	7.5	3.1	EP3220	Cast Iron	US\$9.27
308-17-004	14E1.50 ISO	1.50	14	7.5	3.1	EP3220	Cast Iron	US\$9.27
308-17-005	14E1.75 ISO	1.75	14	7.5	3.1	EP3220	Cast Iron	US\$9.27
308-17-006	14E2.00 ISO	2.00	14	7.5	3.1	EP3220	Cast Iron	US\$9.27
308-17-007	14E2.50 ISO	2.50	14	7.5	3.1	EP3220	Cast Iron	US\$9.27
308-17-008	21E1.00 ISO	1.00	21	12	4.7	EP3220	Cast Iron	US\$11.97
308-17-009	21E1.50 ISO	1.50	21	12	4.7	EP3220	Cast Iron	US\$11.97
308-17-010	21E2.00 ISO	2.00	21	12	4.7	EP3220	Cast Iron	US\$11.97
308-17-011	21E2.50 ISO	2.50	21	12	4.7	EP3220	Cast Iron	US\$11.97
308-17-012	21E3.00 ISO	3.00	21	12	4.7	EP3220	Cast Iron	US\$11.97
308-17-013	30E1.50 ISO	1.50	30	16	5.5	EP3220	Cast Iron	US\$21.94
308-17-014	30E2.00 ISO	2.00	30	16	5.5	EP3220	Cast Iron	US\$21.94
308-17-015	30E3.00 ISO	3.00	30	16	5.5	EP3220	Cast Iron	US\$21.94
308-17-016	30E3.50 ISO	3.50	30	16	5.5	EP3220	Cast Iron	US\$21.94
308-17-017	30E4.00 ISO	4.00	30	16	5.5	EP3220	Cast Iron	US\$21.94
308-17-018	40E1.50 ISO	1.50	40	20	6.3	EP3220	Cast Iron	US\$43.87
308-17-019	40E2.00 ISO	2.00	40	20	6.3	EP3220	Cast Iron	US\$43.87
308-17-020	40E3.00 ISO	3.00	40	20	6.3	EP3220	Cast Iron	US\$43.87
308-17-021	40E4.00 ISO	4.00	40	20	6.3	EP3220	Cast Iron	US\$43.87
308-17-022	40E5.00 ISO	5.00	40	20	6.3	EP3220	Cast Iron	US\$43.87
308-17-023	40E6.00 ISO	6.00	40	20	6.3	EP3220	Cast Iron	US\$43.87



Internal

Order No.	Model	Pitch P(mm)	Insert size			Grade	Application	Unit Price FOB
			A	H	T			
307-17-001	1410.50 ISO	0.50	14	7.5	3.1	EP3220	Cast Iron	US\$9.27
307-17-002	1410.75 ISO	0.75	14	7.5	3.1	EP3220	Cast Iron	US\$9.27
307-17-003	1411.00 ISO	1.00	14	7.5	3.1	EP3220	Cast Iron	US\$9.27
307-17-004	1411.25 ISO	1.25	14	7.5	3.1	EP3220	Cast Iron	US\$9.27
307-17-005	1411.50 ISO	1.50	14	7.5	3.1	EP3220	Cast Iron	US\$9.27
307-17-006	1411.75 ISO	1.75	14	7.5	3.1	EP3220	Cast Iron	US\$9.27
307-17-007	1412.00 ISO	2.00	14	7.5	3.1	EP3220	Cast Iron	US\$9.27
307-17-008	1412.50 ISO	2.50	14	7.5	3.1	EP3220	Cast Iron	US\$9.27
307-17-009	2111.00 ISO	1.00	21	12	4.7	EP3220	Cast Iron	US\$11.97
307-17-010	2111.50 ISO	1.50	21	12	4.7	EP3220	Cast Iron	US\$11.97
307-17-011	2111.75 ISO	1.75	21	12	4.7	EP3220	Cast Iron	US\$11.97
307-17-012	2112.00 ISO	2.00	21	12	4.7	EP3220	Cast Iron	US\$11.97
307-17-013	2112.50 ISO	2.50	21	12	4.7	EP3220	Cast Iron	US\$11.97
307-17-014	2113.00 ISO	3.00	21	12	4.7	EP3220	Cast Iron	US\$11.97
307-17-015	2113.50 ISO	3.50	21	12	4.7	EP3220	Cast Iron	US\$11.97
307-17-016	3011.50 ISO	1.50	30	16	5.5	EP3220	Cast Iron	US\$21.94
307-17-017	3012.00 ISO	2.00	30	16	5.5	EP3220	Cast Iron	US\$21.94
307-17-018	3013.00 ISO	3.00	30	16	5.5	EP3220	Cast Iron	US\$21.94
307-17-019	3013.50 ISO	3.50	30	16	5.5	EP3220	Cast Iron	US\$21.94
307-17-020	3014.00 ISO	4.00	30	16	5.5	EP3220	Cast Iron	US\$21.94
307-17-021	3014.50 ISO	4.50	30	16	5.5	EP3220	Cast Iron	US\$21.94
307-17-022	4011.50 ISO	1.50	40	20	6.3	EP3220	Cast Iron	US\$43.87
307-17-023	4012.00 ISO	2.00	40	20	6.3	EP3220	Cast Iron	US\$43.87
307-17-024	4013.00 ISO	3.00	40	20	6.3	EP3220	Cast Iron	US\$43.87
307-17-025	4013.50 ISO	3.50	40	20	6.3	EP3220	Cast Iron	US\$43.87
307-17-026	4014.00 ISO	4.00	40	20	6.3	EP3220	Cast Iron	US\$43.87
307-17-027	4014.50 ISO	4.50	40	20	6.3	EP3220	Cast Iron	US\$43.87
307-17-028	4015.00 ISO	5.00	40	20	6.3	EP3220	Cast Iron	US\$43.87
307-17-029	4015.50 ISO	5.50	40	20	6.3	EP3220	Cast Iron	US\$43.87
307-17-030	4016.00 ISO	6.00	40	20	6.3	EP3220	Cast Iron	US\$43.87



HSS-COBALT ISO METRIC COARSE THREAD SPIRAL POINT MACHINE TAP

Order No.	Application	Size (d1)	thread length (L2)	Total Length(L1)	Shank Dia. (d2)	Square (a)	Unit Price FOB
DIN371 							
442-12-001	Stainless steel	M3x0.5	11	56	3.5	2.7	US\$1.96
442-12-002	Stainless steel	M4x0.7	13	63	4.5	3.4	US\$1.96
442-12-003	Stainless steel	M5x0.8	16	70	6	4.9	US\$2.20
442-12-004	Stainless steel	M6x1	19	80	6	4.9	US\$2.44
442-12-005	Stainless steel	M8x1.25	22	90	8	6.2	US\$3.71
442-12-006	Stainless steel	M10x1.5	24	100	10	8	US\$4.79
DIN376 							
442-22-007	Stainless steel	M12x1.75	29	110	9	7	US\$6.11
442-22-008	Stainless steel	M14x2	30	110	11	9	US\$8.00
442-22-009	Stainless steel	M16x2	32	110	12	9	US\$11.17
442-22-010	Stainless steel	M18x2.5	34	125	14	11	US\$14.65
442-22-011	Stainless steel	M20x2.5	34	140	16	12	US\$19.69
442-22-012	Stainless steel	M22x2.5	34	140	18	14.5	US\$24.00
442-22-013	Stainless steel	M24x3	38	160	18	14.5	US\$31.46



HSS-COBALT ISO METRIC COARSE THREAD SPIRAL FLUTE MACHINE TAP

Order No.	Application	Size (d1)	thread length (L2)	Total Length(L1)	Shank Dia. (d2)	Square (a)	Unit Price FOB
DIN371 							
443-12-001	Stainless steel	M3x0.5	11	56	3.5	2.7	US\$2.16
443-12-002	Stainless steel	M4x0.7	13	63	4.5	3.4	US\$2.16
443-12-003	Stainless steel	M5x0.8	16	70	6	4.9	US\$2.42
443-12-004	Stainless steel	M6x1	19	80	6	4.9	US\$2.68
443-12-005	Stainless steel	M8x1.25	22	90	8	6.2	US\$4.07
443-12-006	Stainless steel	M10x1.5	24	100	10	8	US\$5.27
DIN376 							
443-22-007	Stainless steel	M12x1.75	29	110	9	7	US\$6.72
443-22-008	Stainless steel	M14x2	30	110	11	9	US\$8.79
443-22-009	Stainless steel	M16x2	32	110	12	9	US\$12.29
443-22-010	Stainless steel	M18x2.5	34	125	14	11	US\$16.12
443-22-011	Stainless steel	M20x2.5	34	140	16	12	US\$21.66
443-22-012	Stainless steel	M22x2.5	34	140	18	14.5	US\$26.40
443-22-013	Stainless steel	M24x3	38	160	18	14.5	US\$34.61



HSS-COBALT ISO METRIC COARSE THREAD SPIRAL POINT MACHINE TAP

Order No.	Application	Size (d1)	thread length (L2)	Total Length(L1)	Shank Dia. (d2)	Square (a)	Unit Price FOB
DIN371 							
442-14-001	Alloy Steel	M3x0.5	11	56	3.5	2.7	US\$1.96
442-14-002	Alloy Steel	M4x0.7	13	63	4.5	3.4	US\$1.96
442-14-003	Alloy Steel	M5x0.8	16	70	6	4.9	US\$2.20
442-14-004	Alloy Steel	M6x1	19	80	6	4.9	US\$2.44
442-14-005	Alloy Steel	M8x1.25	22	90	8	6.2	US\$3.71
442-14-006	Alloy Steel	M10x1.5	24	100	10	8	US\$4.79
DIN376 							
442-24-007	Alloy Steel	M12x1.75	29	110	9	7	US\$6.11
442-24-008	Alloy Steel	M14x2	30	110	11	9	US\$8.00
442-24-009	Alloy Steel	M16x2	32	110	12	9	US\$11.17
442-24-010	Alloy Steel	M18x2.5	34	125	14	11	US\$14.65
442-24-011	Alloy Steel	M20x2.5	34	140	16	12	US\$19.69
442-24-012	Alloy Steel	M22x2.5	34	140	18	14.5	US\$24.00
442-24-013	Alloy Steel	M24x3	38	160	18	14.5	US\$31.46



HSS-COBALT ISO METRIC COARSE THREAD SPIRAL FLUTE MACHINE TAP



Order No.	Application	Size (d1)	thread length (L2)	Total Length(L1)	Shank Dia. (d2)	Square (a)	Unit Price FOB
DIN371 							
443-14-001	Alloy Steel	M3x0.5	11	56	3.5	2.7	US\$2.16
443-14-002	Alloy Steel	M4x0.7	13	63	4.5	3.4	US\$2.16
443-14-003	Alloy Steel	M5x0.8	16	70	6	4.9	US\$2.42
443-14-004	Alloy Steel	M6x1	19	80	6	4.9	US\$2.68
443-14-005	Alloy Steel	M8x1.25	22	90	8	6.2	US\$4.07
443-14-006	Alloy Steel	M10x1.5	24	100	10	8	US\$5.27
DIN376 							
443-24-007	Alloy Steel	M12x1.75	29	110	9	7	US\$6.72
443-24-008	Alloy Steel	M14x2	30	110	11	9	US\$8.79
443-24-009	Alloy Steel	M16x2	32	110	12	9	US\$12.29
443-24-010	Alloy Steel	M18x2.5	34	125	14	11	US\$16.12
443-24-011	Alloy Steel	M20x2.5	34	140	16	12	US\$21.66
443-24-012	Alloy Steel	M22x2.5	34	140	18	14.5	US\$26.40
443-24-013	Alloy Steel	M24x3	38	160	18	14.5	US\$34.61



HSS-COBALT ISO METRIC COARSE THREAD SPIRAL POINT MACHINE TAP

Order No.	Application	Size (d1)	thread length (L2)	Total Length (L1)	Shank Dia. (d2)	Square (a)	Unit Price FOB
DIN371 							
442-11-001	Universal	M3x0.5	11	56	3.5	2.7	US\$1.96
442-11-002	Universal	M4x0.7	13	63	4.5	3.4	US\$1.96
442-11-003	Universal	M5x0.8	16	70	6	4.9	US\$2.20
442-11-004	Universal	M6x1	19	80	6	4.9	US\$2.44
442-11-005	Universal	M8x1.25	22	90	8	6.2	US\$3.71
442-11-006	Universal	M10x1.5	24	100	10	8	US\$4.79
DIN376 							
442-21-007	Universal	M12x1.75	29	110	9	7	US\$6.11
442-21-008	Universal	M14x2	30	110	11	9	US\$8.00
442-21-009	Universal	M16x2	32	110	12	9	US\$11.17
442-21-010	Universal	M18x2.5	34	125	14	11	US\$14.65
442-21-011	Universal	M20x2.5	34	140	16	12	US\$19.69
442-21-012	Universal	M22x2.5	34	140	18	14.5	US\$24.00
442-21-013	Universal	M24x3	38	160	18	14.5	US\$31.46

HSS-COBALT ISO METRIC COARSE THREAD SPIRAL FLUTE MACHINE TAP

Order No.	Application	Size (d1)	thread length (L2)	Total Length (L1)	Shank Dia. (d2)	Square (a)	Unit Price FOB
DIN371 							
443-11-001	Universal	M3x0.5	11	56	3.5	2.7	US\$2.16
443-11-002	Universal	M4x0.7	13	63	4.5	3.4	US\$2.16
443-11-003	Universal	M5x0.8	16	70	6	4.9	US\$2.42
443-11-004	Universal	M6x1	19	80	6	4.9	US\$2.68
443-11-005	Universal	M8x1.25	22	90	8	6.2	US\$4.07
443-11-006	Universal	M10x1.5	24	100	10	8	US\$5.27
DIN376 							
443-21-007	Universal	M12x1.75	29	110	9	7	US\$6.72
443-21-008	Universal	M14x2	30	110	11	9	US\$8.79
443-21-009	Universal	M16x2	32	110	12	9	US\$12.29
443-21-010	Universal	M18x2.5	34	125	14	11	US\$16.12
443-21-011	Universal	M20x2.5	34	140	16	12	US\$21.66
443-21-012	Universal	M22x2.5	34	140	18	14.5	US\$26.40
443-21-013	Universal	M24x3	38	160	18	14.5	US\$34.61

Order No.	Application	Size (d1)	thread length (L2)	Total Length (L1)	Shank Dia. (d2)	Square (a)	Unit Price FOB
DIN371 							
442-13-001	Cast Iron	M3x0.5	11	56	3.5	2.7	US\$1.96
442-13-002	Cast Iron	M4x0.7	13	63	4.5	3.4	US\$1.96
442-13-003	Cast Iron	M5x0.8	16	70	6	4.9	US\$2.20
442-13-004	Cast Iron	M6x1	19	80	6	4.9	US\$2.44
442-13-005	Cast Iron	M8x1.25	22	90	8	6.2	US\$3.71
442-13-006	Cast Iron	M10x1.5	24	100	10	8	US\$4.79
DIN376 							
442-23-007	Cast Iron	M12x1.75	29	110	9	7	US\$6.11
442-23-008	Cast Iron	M14x2	30	110	11	9	US\$8.00
442-23-009	Cast Iron	M16x2	32	110	12	9	US\$11.17
442-23-010	Cast Iron	M18x2.5	34	125	14	11	US\$14.65
442-23-011	Cast Iron	M20x2.5	34	140	16	12	US\$19.69
442-23-012	Cast Iron	M22x2.5	34	140	18	14.5	US\$24.00
442-23-013	Cast Iron	M24x3	38	160	18	14.5	US\$31.46

Order No.	Application	Size (d1)	thread length (L2)	Total Length (L1)	Shank Dia. (d2)	Square (a)	Unit Price FOB
DIN371 							
443-13-001	Cast Iron	M3x0.5	11	56	3.5	2.7	US\$2.16
443-13-002	Cast Iron	M4x0.7	13	63	4.5	3.4	US\$2.16
443-13-003	Cast Iron	M5x0.8	16	70	6	4.9	US\$2.42
443-13-004	Cast Iron	M6x1	19	80	6	4.9	US\$2.68
443-13-005	Cast Iron	M8x1.25	22	90	8	6.2	US\$4.07
443-13-006	Cast Iron	M10x1.5	24	100	10	8	US\$5.27
DIN376 							
443-23-007	Cast Iron	M12x1.75	29	110	9	7	US\$6.72
443-23-008	Cast Iron	M14x2	30	110	11	9	US\$8.79
443-23-009	Cast Iron	M16x2	32	110	12	9	US\$12.29
443-23-010	Cast Iron	M18x2.5	34	125	14	11	US\$16.12
443-23-011	Cast Iron	M20x2.5	34	140	16	12	US\$21.66
443-23-012	Cast Iron	M22x2.5	34	140	18	14.5	US\$26.40
443-23-013	Cast Iron	M24x3	38	160	18	14.5	US\$34.61